

IMPORTANT SAFEGUARDS

When using electrical equipment, basic safety precautions should always be followed including the following:

READ AND FOLLOW ALL SAFETY INSTRUCTIONS

1. **DANGER**- Risk of shock- Disconnect power before installation.
DANGER – *Risque de choc – Couper l'alimentation avant l'installation.*

SAVE THESE INSTRUCTIONS FOR FUTURE REFERENCE

INSTALLATION INSTRUCTIONS INSTRUCTIONS D'INSTALLATION

TO INSTALL:

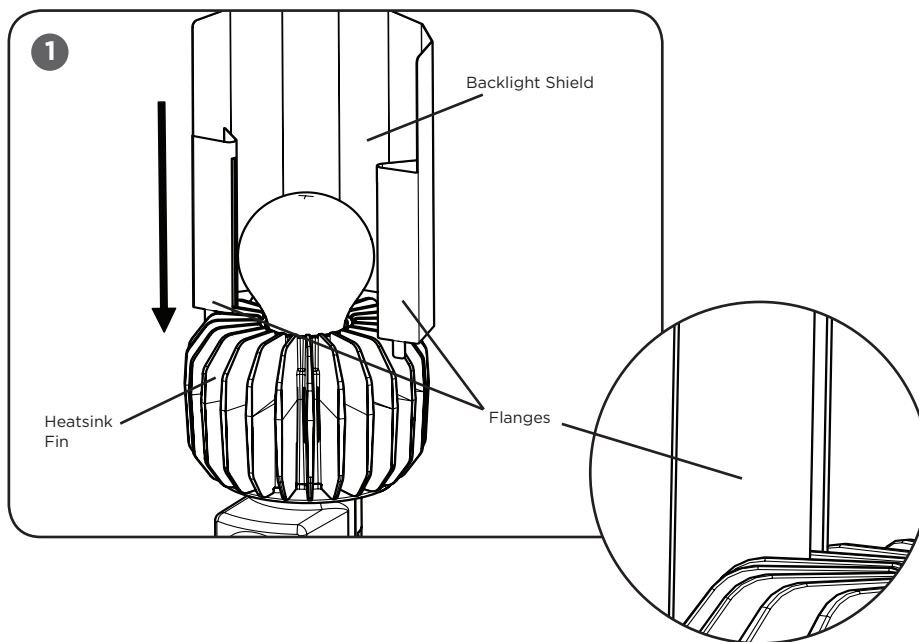

STEP 1:

Attach Backlight Shield to the heatsink's fins by inserting the two flanges on the shield over any (2) fins that are 180° apart. See **Figure 1**.

STEP 2:

Push the Backlight Shield down until the bottom of the flanges are flush with the top of the luminaire base. See **Figure 2**.

